

# DELTA NG 150 R290 115 V / 60 Hz

## SELF-CONTAINED ICE CUBE MACHINE

### FEATURES

- ▶ PRODUCES SOLID GOURMET CRYSTAL CLEAR ICE CUBES
- ▶ A3S: ANTI-SCALE SPRAY SYSTEM. ITV PATENTED SPRAY SYSTEM WITH FLEXIBLE NOZZLES THAT AVOID LIMESCALE DEPOSITS WITH SMALL VIBRATIONS
- ▶ STIF: STRONG INOX FRAME. SOLID MACHINE STRUCTURE IN 4 COLUMNS WITH AISI 304 STAINLESS STEEL FRAME
- ▶ STRONGEST DOOR IN THE MARKET. MADE OF STAINLESS STEEL. OPENING AND DAMPING SYSTEM PATENTED BY ITV
- ▶ FRONT VENTILATION CONCEPT: FRONTAL IN-OUT AIR SYSTEM ALLOWS 'BUILT IN' MACHINES
- ▶ CLEANING SWITCH: ALLOWS CIRCULATION OF WATER WITH DESCALING PRODUCT (CALKLIN OR SIMILAR) WITHOUT COOLING
- ▶ "NEVER STOP" MOTOR PUMP DEVELOPED BY ITV. PUMP WITHOUT SEALS, WHICH AVOIDS DETERIORATION IN HARD WATER
- ▶ EASI: EASY ACCESS FOR SERVICE & INSTALLATION. ALL PANELS CAN BE DISASSEMBLED SEPARATELY
- ▶ ON/OFF LIGHTED ROCKER SWITCH IN FRONT PANEL
- ▶ TROPICALIZED MACHINES (T CLASS) / HEIGHT ADJUSTABLE LEGS FROM 105MM TO 155MM



	24 H	70°F/20°C	50°F/10°C	90°F/32°C	70°F/21°C	<b>lbs (Kg)</b>	<b>in (mm)</b>	<b>in (mm)</b>	
DELTA NG 150 A		<b>143 (65)</b>		<b>130 (59)</b>		<b>55 (25)</b>	Width <b>21.06"</b> (535)	Width <b>24.02"</b> (610)	<b>DELTA 40gr</b> 1.57" (Ø) x 1.73" (H) 40 (Ø) x 44 mm (H) Average dimensions
DELTA NG 150 W		<b>- (-)</b>		<b>- (-)</b>			Depth <b>23.43"</b> (595)	Depth <b>25.99"</b> (660)	
							Height* <b>31.07"</b> (789)	Height <b>40.16"</b> (1.020)	

\* WITH LEGS 35.20"/44.30"(894/1.125)

### ACCESSORIES

#### INCLUDED



6" HEIGHT ADJUSTABLE LEG KIT

SCOOP

#### NOT INCLUDED (OPTIONAL)

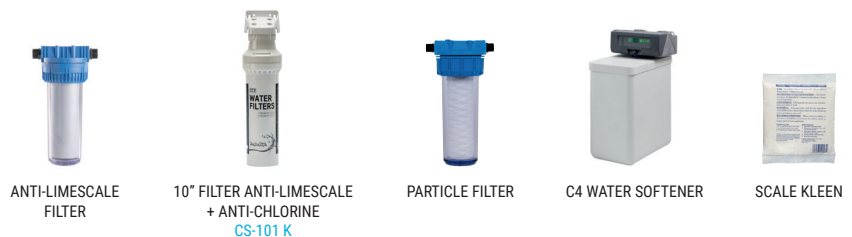

ANTI-LIMESCALE FILTER

10" FILTER ANTI-LIMESCALE + ANTI-CHLORINE CS-101 K

PARTICLE FILTER

C4 WATER SOFTENER

SCALE KLEEN

# TECHNICAL SCHEME

## DELTA NG 150

LEFT SIDE VIEW

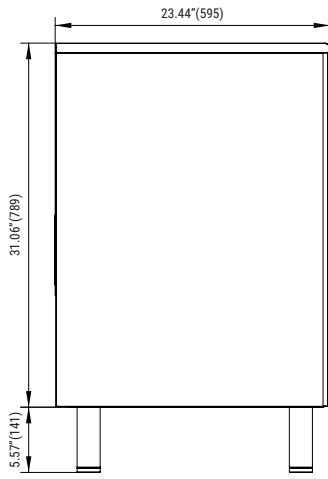

FRONTAL VIEW

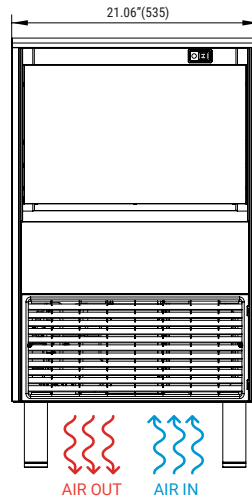

REAR VIEW

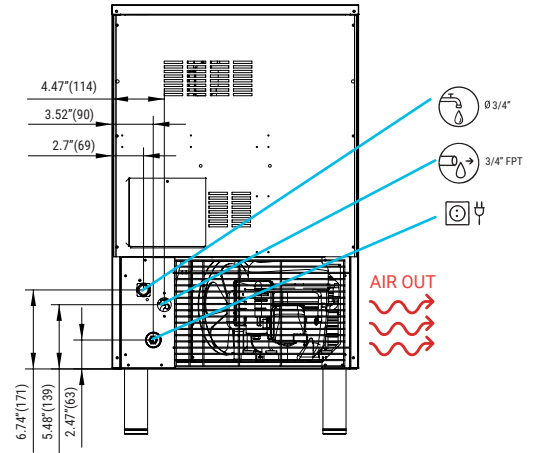

\* All dimensions in inches (and mm)

## OPERATING CONDITIONS

### PRODUCTION (LBS) 60Hz

±10% V

41°F/109°F

41°F/95°F

14.5 psi (1 bar) / 87 psi (6 bar)

36 Ice cubes/cycle



V	Hz	ph
115	60	1N



### DELTA NG 150 AIR COOLED

°F / °C	50° / 10°	60° / 15°	70° / 21°	86° / 30°
50° / 10°	148	141	139	134
68° / 20°	145	139	137	132
90° / 32°	139	132	130	126
109° / 43°	119	114	112	106



### DELTA NG 150 WATER COOLED

°F / °C	50° / 10°	60° / 15°	70° / 21°	86° / 30°
50° / 10°	-	-	-	-
68° / 21°	-	-	-	-
90° / 32°	-	-	-	-
109° / 43°	-	-	-	-

## MODELS

DELTA NG 150 A

DELTA NG 150 W

	ASHRAE CONDITIONS (BTu/h) (W)	(W) 109°F	(A)	(AWG/mm²) (n.)	FUSE	100lbs (Kwh/100 lbs) (90°F / 70°F)	gal (l/h) (100lbs)	HEAT REJECTED (BTu/h) (W)	(lbs)	(lbs)
DELTA NG 150 A	4,163 1,220	390	-	16/1.5 3	10	6.7	31.6 2.6	3,333 889	136	149
DELTA NG 150 W	-	-	-	-	-	-	-	-	-	-



ITV Ice Makers, Inc.  
9550 Satellite Blvd, Suite 100  
Orlando, FL 32837  
Phone: 1 407 826 1860 | Fax: 1 407 826 1861  
Toll Free: 1 888 488 1423  
sales@itvice.com | www.itvice.com



SERVICE  
service@itvice.com  
Skype: service@itvice.com  
PHONE: +1 888 488 1423  
FROM 8AM TO 5PM EST



2 ADDITIONAL YEARS  
ON COMPRESSOR &  
EVAPORATOR  
Read our warranty policy  
to know more about  
limitations and exclusions

